



PIPELINE INSPECTION



CAR INSPECTION



AIR CONDITIONER INSPECTION



SEWER DETECT

Product Features:

Cable length 1m, 1.5m, 2m, 3.5m, 5m, 10m and 20m can be available for this USB endoscope .

Camera Specifications: Camera 1/5"VGA COMS

Pixel 0.3MP

Resolution :YUV:640*480; , F/NO 2.8

LED 6 White LED bright light,

Camera housing diameter Φ 5.5mm

Wide visual view angle 62°

LED switch Adjustable lightness switch Waterproof IP67

Focal Distance 6CM-infinite

I/O Interface:Micro usb or USB 0.3 Packing details: endoscope camera, CD,manual

Wifi Box Specifications:

1. WIFI wireless connection;
2. Built in lithium battery 850MAH;Battery usage time 2-3 hours
3. Support Android mobile phones, apple phones, tablet PCs, laptops, and all the WIFI features of mobile phones and computers. But desktop computers need to add USB wireless network card;
4. It can take pictures and videos, and save in the mobile phone or computer equipment.
5. It can connect up to 4 sets of equipment at the same time.
6. Support any USB interface camera connection, just need to plug into the WIFI box, USB dental endoscope, USB microscope, USB computer QQ camera, USB endoscope.

Technical parameter:

Project: Description

WIFI distance: 30 meters

Item size: 63.7*40*16.7mm

Power: 5V

Connector: USB 2.0

Camera: 2000,000pixels

Resolution: 640*480

Auxiliary light source: 6LED Bright lights

Lens F / NO: 2.8

OD: ϕ 9mm

Angle of view: 60°

LED light switch: Adjustable

Focal distance: 3CM-6CM

format: priority MJPG

Mobile download software:

A. After WIFI box connected to the camera, the WIFI box built in 5V battery 850MAH power supply.

B. Please download the corresponding mobile phone system APP, Android APP or Apple APP.

Product Pictures:

Wifi endoscope



5.5mm



<http://www.selectech.cn>

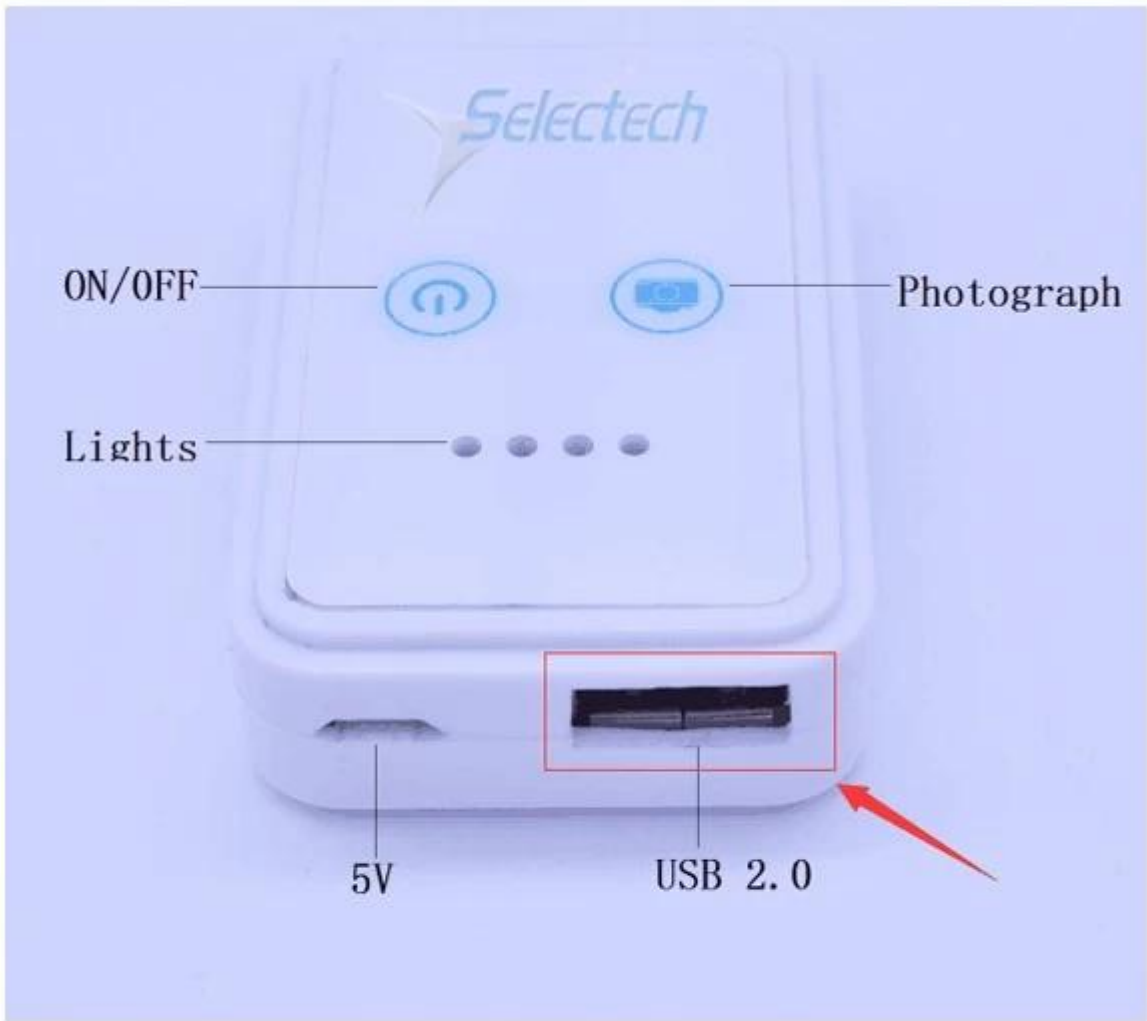

<http://www.selectechcn.com>



<http://www.selectechcn.com>





<http://www.selectechcn.com>

Product Packaging:

- 1 * Mini USB Endoscope
- 1 * Wifi Box
- 1 * Magnet
- 1 * Mirror
- 1 * Fixed set
- 1 * Small hook
- 1* CD
- 1 * Manual

