

AC / USB wall outlets - Convenient and power-efficient in-wall solutions for powering and recharging USB devices.



### Smart design

Wall socket dual USB chargers use advanced technology to provide the most efficient charging for each device.

The USB port is controlled by a smart chip that recognizes the charging requirements of each unique device and optimizes the current to reduce charging time.

This allows users to spend less time waiting for the device to charge and more time enjoying them. The USB port is type A 2.0, with a combined power of 2.4 amps.

The USB charger duplex socket has two high power ports and is ideal for charging tablets and other high performance portable devices.

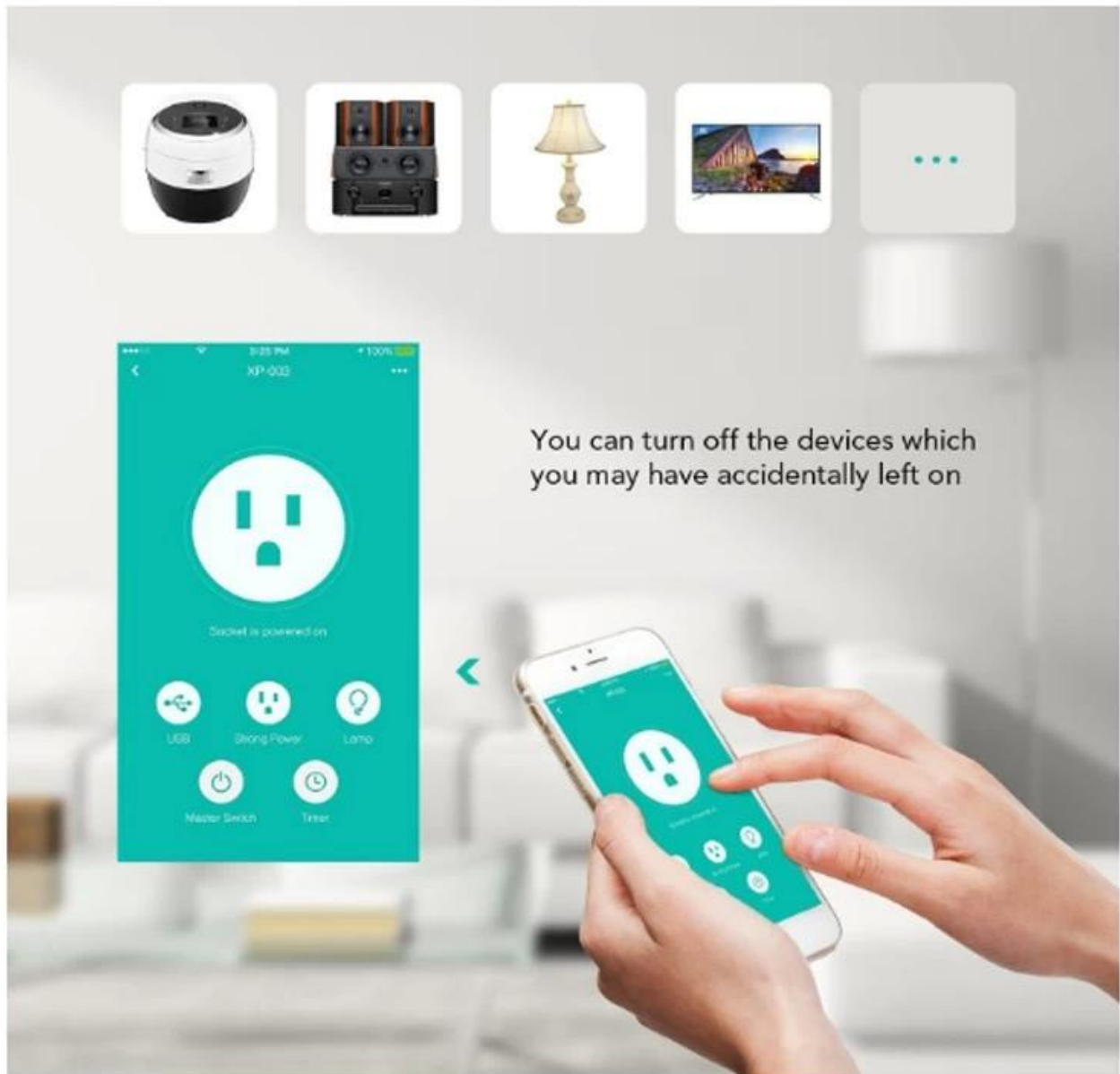

## Electrical Specifications

AC input parameters: AC125V /15A

USB output: DC5V 4.8A

Terminal Blocks: #14--#10AWG

Operating temperature: -4 to 140°F (-20 to 60°C)

USB Compatibility: USB 1.1 / 2.0 / 3.0 Devices, Including Apple Products

Stripping length: 0.5in (back hole), 1in (screw terminal)

Medium Voltage: Tolerated 2000V / UL 498

Compatibility:

Apple iPad (all models)\*

Apple iPhone (all models)

Apple iPod (all USB charging models)

Android™ tablets and mobile phones, tablets, mobile phones, game systems (Nintendo, Sony PSP, etc.), Bluetooth headsets,

Digital camera or GPS device charged via standard USB plug

